

Peninsula Link

Come and enjoy a FREE sausage and get the latest Peninsula Link update

When

Monday, 28 March 2011,
5:30pm to 7:30pm

Where

Baxter Community Hall
211 Baxter-Tooradin
Road, Baxter
(Melway Ref: 107 D5)



You are invited to a free sausage sizzle and a chat with Peninsula Link staff on Monday, 28 March 2011 from 5:30pm to 7:30pm at the Baxter Community Hall.

Project specialists from construction, urban design, landscape design, environmental management and acoustic modelling will be on hand to answer questions.

Baxter information session 4D model

A computer model of Peninsula Link through Baxter will be running on the night. This 4D model allows residents to view what Peninsula Link will look like from their properties on a large screen. See images below.

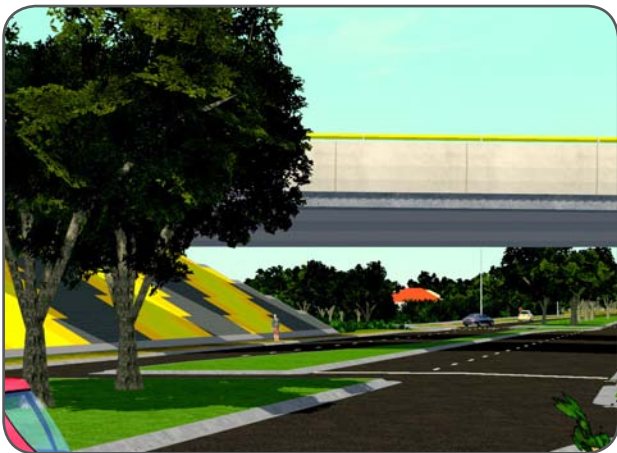

Baxter Construction Update

March 2011

Works are continuing to ramp up in Baxter and there will be a lot happening in the coming months. Here are some of the activities planned for your area.

Baxter-Tooradin Road and Frankston-Flinders Road, Baxter

Culverts are being installed to allow local waterways such as the Watson and Balcombe creeks to travel underneath the freeway. Service relocations in this area will be ongoing for the next two months.

Mornington Tourist rail line, Baxter

Piling works are complete and construction of the retaining walls is underway.

Piling works

Piling works for the bridges over Baxter-Tooradin and Frankston-Flinders roads are scheduled to commence in mid to late March. The piling works will create short term but substantial noise as the piles are hammered into the ground. Piling works are expected to last approximately four weeks.

For further information on the works outlined in this Community Notice, please phone our 24-hour hotline on 1300 453 035, or email contact@peninsulalink.com.au.

Kind regards

Carol Bartley
Stakeholder Engagement Manager
28 February 2011

Construction hours

Construction hours are generally Monday to Friday between 7am and 6pm and on Saturdays between 7am and 4pm, with occasional out-of-hours works, such as night works, as required. Any construction related impacts, such as noise, will be closely monitored throughout the works.

Please travel with care and observe directions provided by variable message signs and traffic controllers. Thank you for your cooperation and patience during construction.

Contact Details

Phone 1300 453 035
Email contact@peninsulalink.com.au
Web www.peninsulalink.com.au

Peninsula Link Info Hub (Display Centre)
Level 1, 405 Nepean Highway, Frankston
Opening Hours
Wednesdays to Fridays: 10am - 4pm
Third Saturday of the month: 10am-1pm



If you require the assistance of an interpreter please phone (03) 9280 0753

